

TNB-190LU2

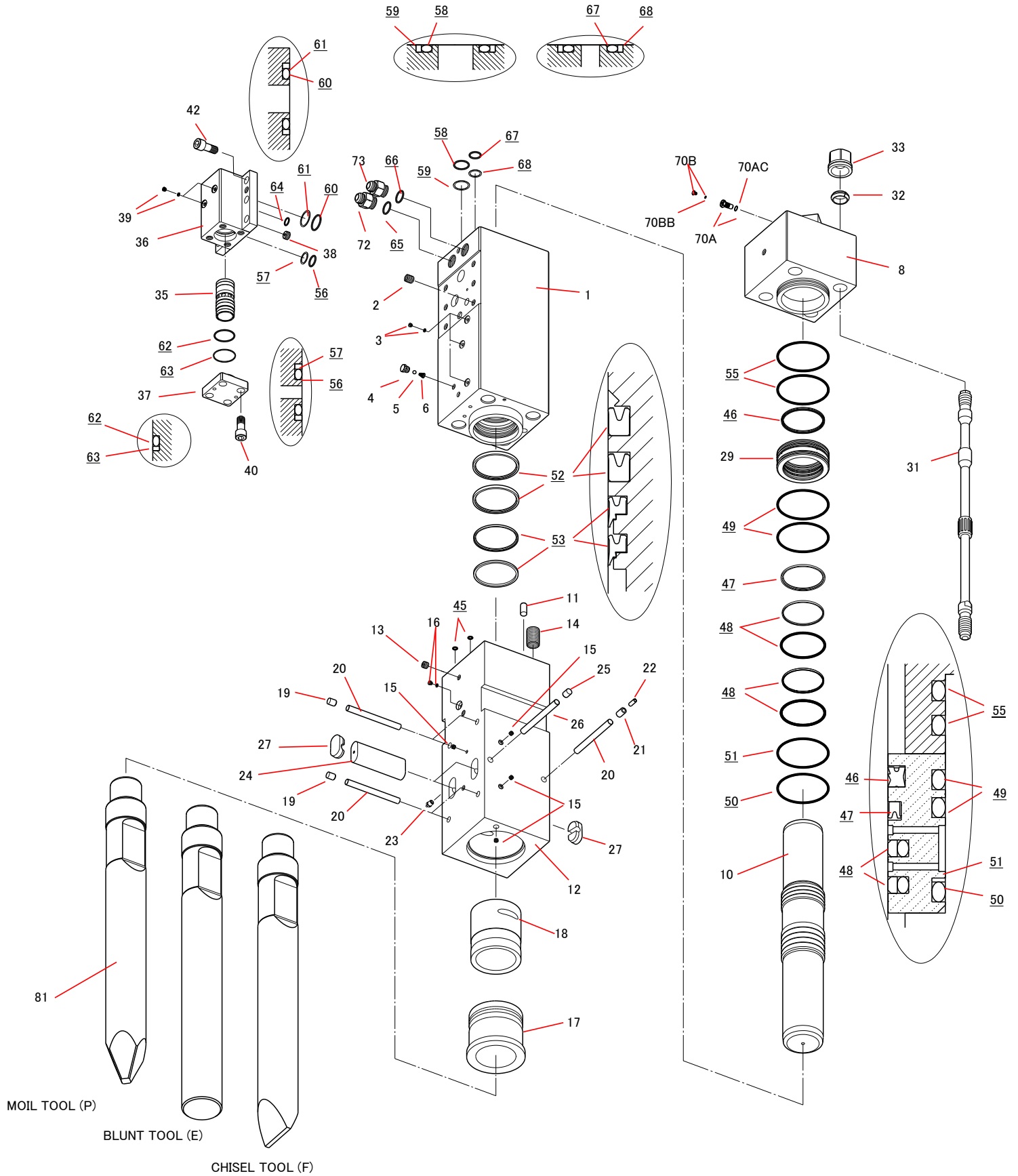

Parts

2019.04.24

No.1

Sym	Part Code	Description	Q'ty	Ser.No.	Int	Remarks	Kit
	41502701C	CYLINDER CP	1	10057~			
1	415027010	CYLINDER	1	10057~			C
2	131030013	HELISERT	6	10057~			C
3	134912002	HEX SOCKET FLANGE PLUG	3	10057~			C
	41514366A	AIR CAP CP	1	10057~			C
4	415143660	AIR CAP	1	10057~			A,C
5	130505028	BALL	1	10057~			A,C
6	130806014	AIR CAP SPRING	1	10057~			A,C
8	415189030	CYLINDER COVER	1	10057~			
10	415189041	PISTON	1	10057~			
11	415618U30	LOCK PIN	1	10057~			
	41562805D	CHISEL HOLDER CP	1	10057~			
12	415628051	CHISEL HOLDER	1	10057~			H
13	134901104	PLUG	1	10057~			H
14	131048015	HELISERT	4	10057~			H
15	134901102	PLUG	4	10057~			H
16	182136006	O-RING PLUG	1	10057~			H
17	415628060	CHISEL BUSHING	1	10057~			H
18	415189140	CHISEL HOLDER BUSHING	1	10057~			H
19	136402015	PLUG	4	10057~			H
20	415189251	STOPPER PIN	5	10057~			H
21	130620030	SPRING PIN	1	10057~			H
22	130613030	SPRING PIN	1	10057~			H
23	135013002	GREASE NIPPLE	1	10057~			H
24	415189100	RETAINER PIN	2	10057~			
25	136402015	PLUG	1	10057~			
26	415189251	STOPPER PIN	1	10057~			
27	136402041	RETAINER PIN PLUG	4	10057~			
29	415628130	PACKING BUSHING	1	10057~			
31	415189160	SIDE BOLT	4	10057~			
32	136306019	SIDE BOLT RING	4	10057~			
33	134206019	SIDE BOLT NUT	4	10057~			
35	415156200	CONTROL VALVE	1	10057~			
36	415679210	CONTROL VALVE BOX	1	10057~			
37	415156221	CONTROL VALVE CAP	1	10057~			
38	415156230	CHOKE PLUG	1	10057~			
39	134912002	HEX SOCKET FLANGE PLUG	2	10057~			
40	131730260	HEX SOCKET HEAD CAP SCREW	4	10057~			
42	131730290	HEX SOCKET HEAD CAP SCREW	6	10057~			
45	131101013	O-RING	2	10057~			S
46	131220190	GAS SEAL	1	10057~			S
47	131225190	OIL SEAL	1	10057~			S
48	131230190	SLIDE RING S	2	10057~			S
49	131102032	O-RING	2	10057~			S

Sym	PART CODE	DESCRIPTION	Q'ty	Ser.No.	INT	REMARKS	Kit
50	131102132	O-RING	1	10057~			S
51	131122032	BACK-UP RING	1	10057~			S
52	131225270	OIL SEAL	2	10057~			S
53	131219270	DUST SEAL	2	10057~			S
55	131102032	O-RING	2	10057~			S
56	131101036	O-RING	2	10057~			S,V
57	131121036	BACK-UP RING	2	10057~			S,V
58	131101055	O-RING	1	10057~			S
59	131121055	BACK-UP RING	1	10057~			S
60	131101057	O-RING	2	10057~			S,V
61	131121057	BACK-UP RING	2	10057~			S,V
62	131102013	O-RING	1	10057~			S,V
63	131122013	BACK-UP RING	1	10057~			S,V
64	131108023	O-RING	1	10057~			S
65	131108038	O-RING	1	10057~			S
66	131108038	O-RING	1	10057~			S
67	131101036	O-RING	1	10057~			S
68	131121036	BACK-UP RING	1	10057~			S
	41514130K	GAS VALVE CP	1	10057~			
70A	41514130L	GAS VALVE BODY CP	1	10057~			G
70AC	131101015	O-RING	1	10057~			G
70B	41514132E	GAS VALVE PLUG CP	1	10057~			G
70BB	131101004	O-RING	1	10057~			G
72	182092220	HOSE ADAPTER-IN (w/O-RING)	1	10057~		1-5/16-12UNF	
73	182092221	HOSE ADAPTER-OUT (w/O-RING)	1	10057~		1-5/16-12UNF	
81	415189412	MOIL TOOL (P) 140x1500L	1	10057~		L=1500	
82	415189422	BLUNT TOOL (E) 140x1500L	0	10057~		L=1500	
83	415189432	CHISEL TOOL (F) 140x1500L	0	10057~		L=1500	
	41562880D	SEAL KIT	1	10057~			
	41515680G	CONTROL VALVE SEAL KIT	1	10057~			

Air Cap CP consists of part marked "A"
(#4, 5, & 6 NOT sold separately)

Seal Kit consists of the parts marked "S".
(Individual seals NOT sold separately)

Cylinder CP consists of the parts marked "C".

O-RING is included to #72 & #73

Chisel Holder CP consists of the parts marked "H".

INT(interchangibility)

Gas Valve CP consists of the parts marked "G"
(#70A, 70AC & 70BB NOT sold separately)

○ Interchangeable old ↔ new

△ Interchangeable old → new

▲ Interchangeable old ← new

Control Valve Seal Kit consists of parts marked "V"
(Individual seals NOT sold separately)

× Not interchangeable