

TNB-190LU1

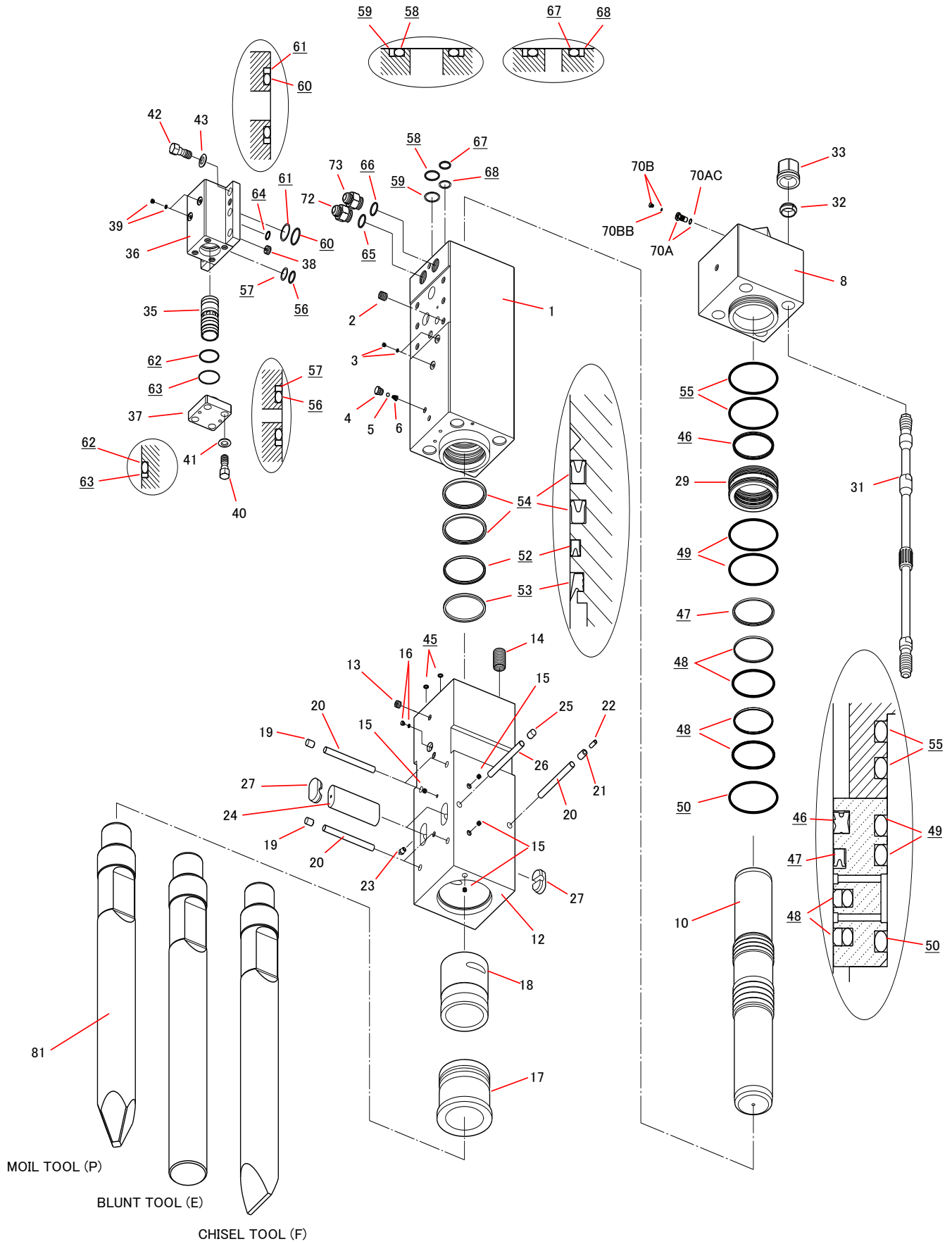

Parts

2015.10.15

No.1

Sym	Part Code	Description	Q'ty	Ser.No.	Int	Remarks	Kit
	41567701H	CYLINDER CP	1	11361-			
1	415677012	CYLINDER	1	11361-			C
2	131030013	HELISERT	6	11361-			C
3	134912002	HEX SOCKET FLANGE PLUG	2	11361-			C
	41514366A	AIR CAP CP	1	11361-			C
4	415143660	AIR CAP	1	11361-			A,C
5	130505028	BALL	1	11361-			A,C
6	130806014	AIR CAP SPRING	1	11361-			A,C
8	415189030	CYLINDER COVER	1	11361-			
10	415189041	PISTON	1	11361-			
	41562805C	CHISEL HOLDER CP	1	11361-			
12	415628050	CHISEL HOLDER	1	11361-			H
13	134901104	PLUG	1	11361-			H
14	131048015	HELISERT	4	11361-			H
15	134901102	PLUG	4	11361-			H
16	182136006	O-RING PLUG	1	11361-			H
17	415628060	CHISEL BUSHING	1	11361-			H
18	415189140	CHISEL HOLDER BUSHING	1	11361-			H
19	136402011	PLUG	4	11361-			H
20	415189250	STOPPER PIN	5	11361-			H
21	130620030	SPRING PIN	1	11361-			H
22	130613030	SPRING PIN	1	11361-			H
23	135013002	GREASE NIPPLE	1	11361-			H
24	415189100	RETAINER PIN	2	11361-			
25	136402011	PLUG	1	11361-			
26	415189250	STOPPER PIN	1	11361-			
27	136402041	RETAINER PIN PLUG	4	11361-			
29	415189130	PACKING BUSHING	1	11361-			
31	415189160	SIDE BOLT	4	11361-			
32	136306019	SIDE BOLT RING	4	11361-			
33	134206019	SIDE BOLT NUT	4	11361-			
35	415156200	CONTROL VALVE	1	11361-			
36	415679210	CONTROL VALVE BOX	1	11361-			
37	415156221	CONTROL VALVE CAP	1	11361-			
38	415156230	CHOKE PLUG	1	11361-			
39	134912002	HEX SOCKET FLANGE PLUG	2	11361-			
40	131506022	HEX BOLT	4	11361-			
41	131313130	WASHER	4	11361-			
42	131506023	HEX BOLT	6	11361-			
43	131313130	WASHER	6	11361-			
45	131101013	O-RING	2	11361-			S
46	131220190	GAS SEAL	1	11361-			S
47	131225190	OIL SEAL	1	11361-			S
48	131230190	SLIDE RING S	2	11361-			S

Sym	Part Code	Description	Q'ty	Ser.No.	Int	Remarks	Kit
49	131102032	O-RING	2	11361-			S
50	131102132	O-RING	1	11361-			S
52	131225191	OIL SEAL	1	11361-			S
53	131219190	DUST SEAL	1	11361-			S
54	131227191	BUFFER RING	2	11361-			S
55	131102032	O-RING	2	11361-			S
56	131101036	O-RING	2	11361-			S,V
57	131121036	BACK-UP RING	2	11361-			S,V
58	131101055	O-RING	1	11361-			S
59	131121055	BACK-UP RING	1	11361-			S
60	131101057	O-RING	2	11361-			S,V
61	131121057	BACK-UP RING	2	11361-			S,V
62	131102013	O-RING	1	11361-			S,V
63	131122013	BACK-UP RING	1	11361-			S,V
64	131108023	O-RING	1	11361-			S
65	131108038	O-RING	1	11361-			S
66	131108038	O-RING	1	11361-			S
67	131101036	O-RING	1	11361-			S
68	131121036	BACK-UP RING	1	11361-			S
	41514130J	GAS VALVE CP	1	11361-			
70A	41514130G	GAS VALVE BODY CP	1	11361-			G
70AC	131101015	O-RING	1	11361-			G
70B	41514132E	GAS VALVE PLUG CP	1	11361-			G
70BB	131101004	O-RING	1	11361-			G
72	182092220	HOSE ADAPTER-IN (WITH O-RING)	1	11361-		1-5/16-12UNF	
73	182092221	HOSE ADAPTER-OUT (WITH O-RING)	1	11361-		1-5/16-12UNF	
81	415189411	MOIL TOOL (P) 140x1500L	1	11361-		L=1500	
82	415189421	BLUNT TOOL (E) 140x1500L	0	11361-		L=1500	
83	415189431	CHISEL TOOL (F) 140x1500L	0	11361-		L=1500	
	41567780L	SEAL KIT	1	11361-			
	41515680G	CONTROL VALVE SEAL KIT	1	11361-			

Air Cap CP consists of part marked "A"
(#4, 5, & 6 NOT sold separately)

Seal Kit consists of the parts marked "S".
(Individual seals NOT sold separately)

Cylinder CP consists of the parts marked "C".

O-RING is included to #72 & #73

Chisel Holder CP consists of the parts marked "H".

INT(interchangeability)

Gas Valve CP consists of the parts marked "G"
(#70A, 70AC & 70BB NOT sold separately)

○ Interchangeable old ⇔ new

△ Interchangeable old → new

▲ Interchangeable old ← new

Control Valve Seal Kit consists of parts marked "V"
(Individual seals NOT sold separately)

× Not interchangeable