

# TNB-151LU1

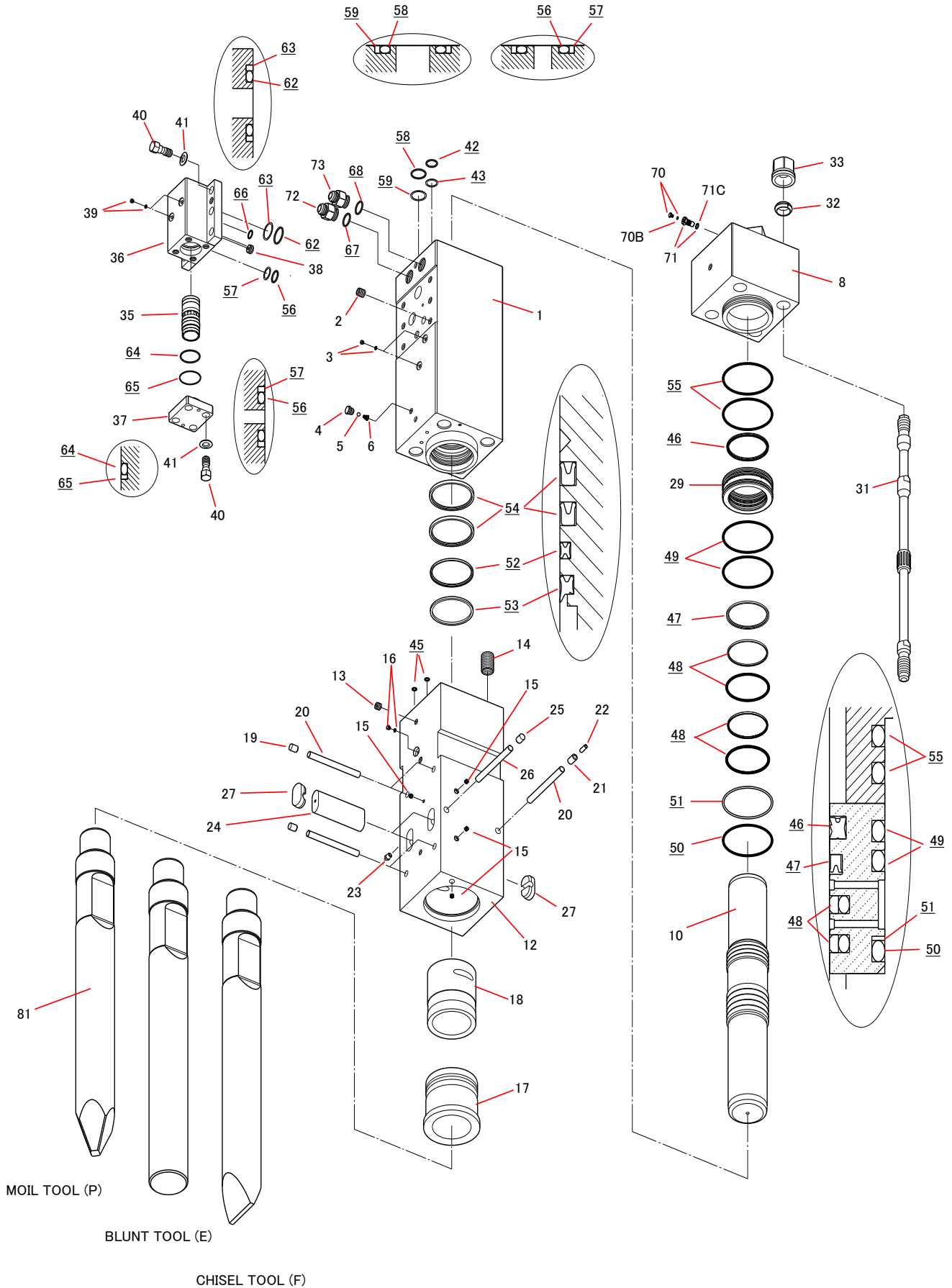

# Parts

2015.04.03

No.5

Sym	Part Code	Description	Q'ty	Ser.No.	Int	Remarks	Kit
	41569401M	CYLINDER CP	1	10001~			
1	415694012	CYLINDER	1	10001~			C
2	131024010	HELISERT	6	10001~			C
3	134912002	HEX SOCKET FLANGE PLUG	2	10001~			C
	41514366A	AIR CAP CP	1	10001~			C
4	415143660	AIR CAP	1	10001~			A,C
5	130505028	BALL	1	10001~			A,C
6	130806014	AIR CAP SPRING	1	10001~			A,C
8	415185030	CYLINDER COVER	1	10001~			
10	415693040	PISTON	1	10001~			
	41560905D	CHISEL HOLDER CP	1	10001~			
12	415609050	CHISEL HOLDER	1	10001~			H
13	134901104	PLUG	1	10001~			H
14	131042015	HELISERT	4	10001~			H
15	134901102	PLUG	4	10001~			H
16	182136006	O-RING PLUG	1	10001~			H
17	415609060	CHISEL BUSHING	1	10001~			H
18	415148140	CHISEL HOLDER BUSHING	1	10001~			H
19	136402011	PLUG	4	10001~			H
20	415148250	STOPPER PIN	5	10001~			H
21	130620030	SPRING PIN	1	10001~			H
22	130613030	SPRING PIN	1	10001~			H
23	135013002	GREASE NIPPLE	1	10001~			H
24	415186100	RETAINER PIN	2	10001~			
25	136402011	PLUG	1	10001~			
26	415148250	STOPPER PIN	1	10001~			
27	136402040	RETAINER PIN PLUG	4	10001~			
29	415609130	PACKING BUSHING	1	10001~			
31	415185161	SIDE BOLT	4	10001~	▲		
	415185160	SIDE BOLT	4	10001~			
32	136306016	SIDE BOLT RING	0	10001~			
	136306016	SIDE BOLT RING	4	10001~			
33	134206018	SIDE BOLT NUT	4	10001~	▲		
	134206017	SIDE BOLT NUT	4	10001~			
35	415147200	CONTROL VALVE	1	10001~			
36	415694210	CONTROL VALVE BOX	1	10001~			
37	415147220	CONTROL VALVE CAP	1	10001~			
38	415156230	CHOKE PLUG	1	10001~			
39	134912002	HEX SOCKET FLANGE PLUG	2	10001~			
40	131506010	HEX BOLT	10	10001~			
41	131313124	WASHER	10	10001~			
42	131101034	O-RING	1	10001~			S
43	131121034	BACK-UP RING	1	10001~			S
45	131101013	O-RING	2	10001~			S
46	131220150	GAS SEAL	1	10001~			S
47	131225150	OIL SEAL	1	10001~			S

Sym	Part Code	Description	Q'ty	Ser.No.	Int	Remarks	Kit
48	131230150	SLIDE RING S	2	10001~			S
49	131102029	O-RING	2	10001~			S
50	131102129	O-RING	1	10001~			S
51	131122026	BACK-UP RING	1	10001~			S
52	131233150	X-SEAL	1	10001~			S
53	131219150	DUST SEAL	1	10302~	▲		S
	131219140	DUST SEAL	1	10001~10301			S
54	131227152	BUFFER RING	2	10302~	▲		S
	131227151	BUFFER RING	2	10001~10301			S
55	131102029	O-RING	2	10001~			S
56	131101034	O-RING	2	10001~			S,V
57	131121034	BACK-UP RING	2	10001~			S,V
58	131101045	O-RING	1	10001~			S
59	131121045	BACK-UP RING	1	10001~			S
62	131101049	O-RING	2	10001~			S,V
63	131121049	BACK-UP RING	2	10001~			S,V
64	131102010	O-RING	1	10001~			S,V
65	131122010	BACK-UP RING	1	10001~			S,V
66	131108023	O-RING	1	10001~			S
67	131108038	O-RING	1	10001~			S
68	131108038	O-RING	1	10001~			S
	41514130J	GAS VALVE CP	1	10394~	▲		
70	41514132E	GAS VALVE PLUG CP	1	10394~	▲		G
70B	131101004	O-RING	1	10001~			G
71	41514130G	GAS VALVE BODY CP	1	10001~			G
71C	131101015	O-RING	1	10001~			G
72	136096254	HOSE ADAPTER, IN (w/O-Ring)	1	10001~		1-5/16-12UNF	
73	136096253	HOSE ADAPTER, OUT (w/O-Ring)	1	10001~		1-5/16-12UNF	
81	415186412	MOIL TOOL (P) 135x1230L	1	10001~	▲	L=1230	
	415186422	BLUNT TOOL (E) 135x1230L	0	10001~	▲	L=1230	
	415186432	CHISEL TOOL (F) 135x1230L	0	10001~	▲	L=1230	
	41560980H	SEAL KIT	1	10302~	▲		
	41514780G	CONTROL VALVE SEAL KIT	1	10001~			

Air Cap CP consists of part marked "A"  
(#4, 5, & 6 NOT sold separately)

Seal Kit consists of the parts marked "S".  
(Individual seals NOT sold separately)

Cylinder CP consists of the parts marked "C".

Contral Valve Seal Kit consists of parts marked "V"  
(Individual seals NOT sold separately)

Chisel Holder CP consists of the parts marked "H".

INT(interchangeability)

Gas Valve CP consists of the parts marked "G"  
(#70B, 71 & 71C NOT sold separately)

○ Interchangeable old ↔ new

△ Interchangeable old → new

▲ Interchangeable old ← new

O-RING is included to #72 & #73 UNF type HOSE ADAPTER.

× Not interchangeable

Long chisel and Core Chisel is an option.